

**Ball screw drive with full protection**

**Lubricating nipples are easily accessible for ease of maintainability.**

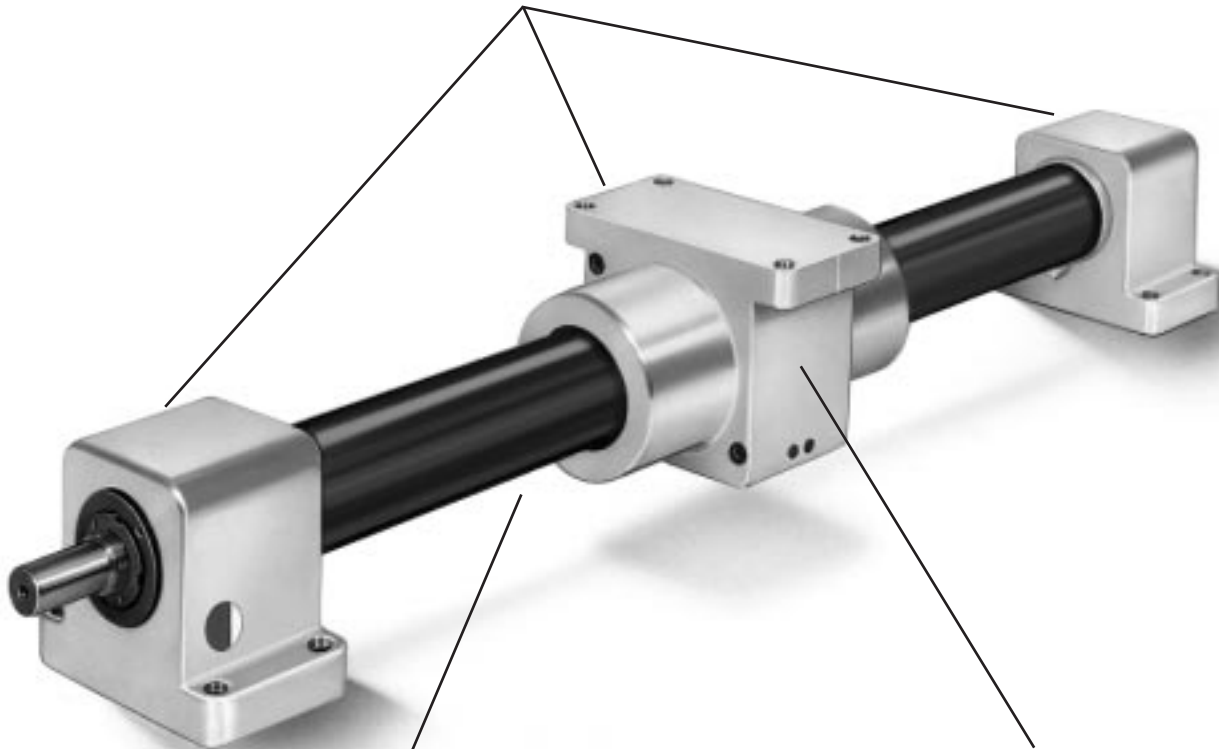

**Central housing with pre-loaded nut unit and cover band guide (can be fitted in different positions).**

**Impact-resistant KOKON™ protective bands made of PA 12 elastomer.**

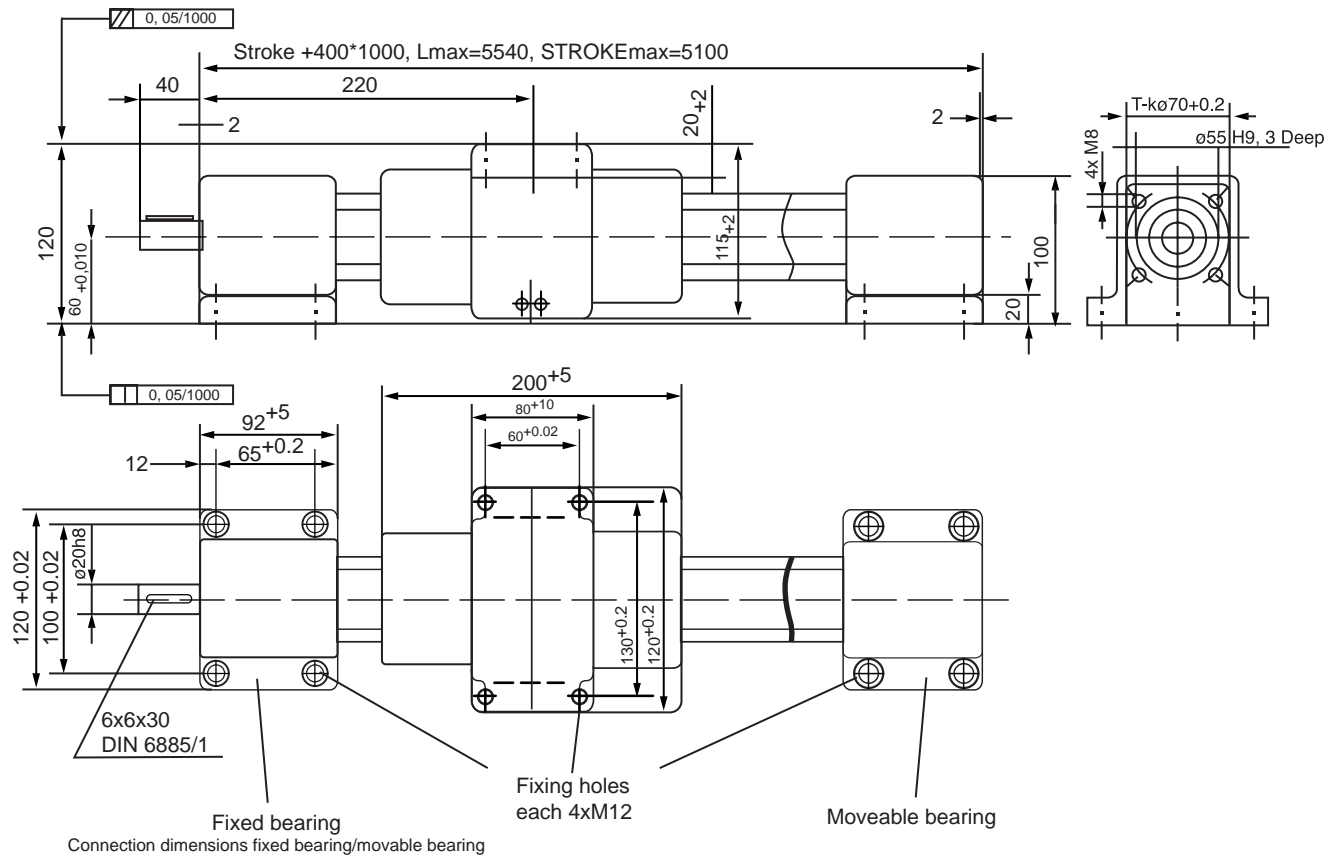

## Technical data:

Process speed:	max. 0.5 m/s
Repeatability:	± 0.05 mm
Acceleration:	max. 20 m/s <sup>2</sup>
Drive unit:	KGS 4005/4010
Speed:	max. 3000 RPM
Idling torque M <sub>0</sub> :	1.6 ± 0.4 Nm
Axial load ratings C <sub>0</sub> :	46,000 N
C:	42,000 N
Efficiency η:	0.75

### Weights

basic without stroke:	4.40 kg
100 mm stroke:	0.95 kg
nut unit with housing:	3.60 kg

### Material properties of the cover band

Material:	PA12
Modulus of elasticity:	300 N/mm <sup>2</sup>
Breaking strength:	40 N/mm <sup>2</sup>
Shore hardness:	54
Water absorption:	max. 1.4%
Oil and coolant resistant	

## Accessories

### Motor Covers

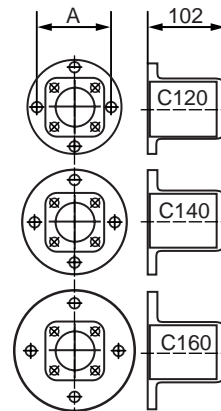

	A
C120	100
C140	115
C160	130

Order code: p. 36